



Instructions

ATK - BIKE MOUNT

This document is to be used as an aid when installing a single instance of our ATK - Bike Mount. If you have any questions along the way, please don't hesitate to give us a call at 385.202.4188.

Hardware included:

M8x20mm Bolt	20	M8 Nylock Nut	20
M6x12mm Bolt	16	M6 Nylock Nut	16
Eye Bolt	2	Eye Bolt Nut	2
Eye Bolt Washers	4	Ubolt Plates	2
Ubolts	2	Ubolt Nuts	4

Diagram 1 will show you an overall layout of how the components go together. The later diagrams will show hidden areas better. Frame brackets will clamp onto frame rails. With that said, the assembly can be adjusted front/back to suit your particular configuration. These diagrams show the assembly installed with the bike facing the passenger side, but the mount can be installed either way.

Diagram 1

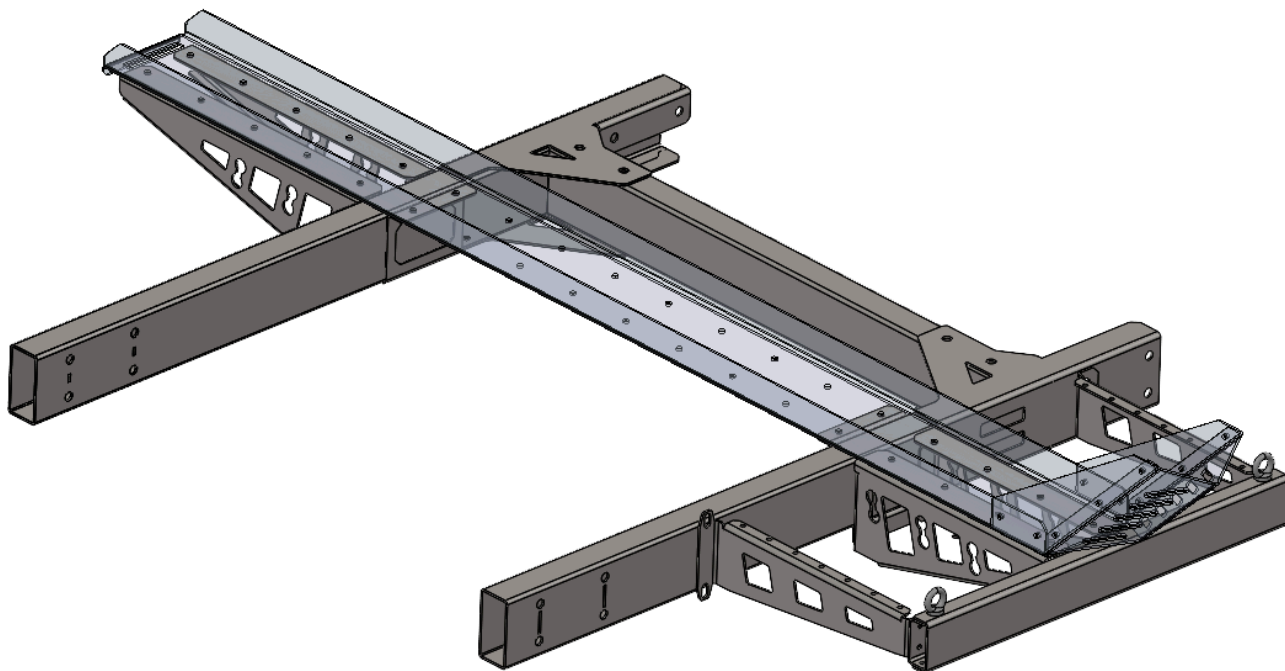

1: Assemble tray pieces using (10) M6x12mm bolts and M6 Nuts. See *diagram 2*.

Diagram 2

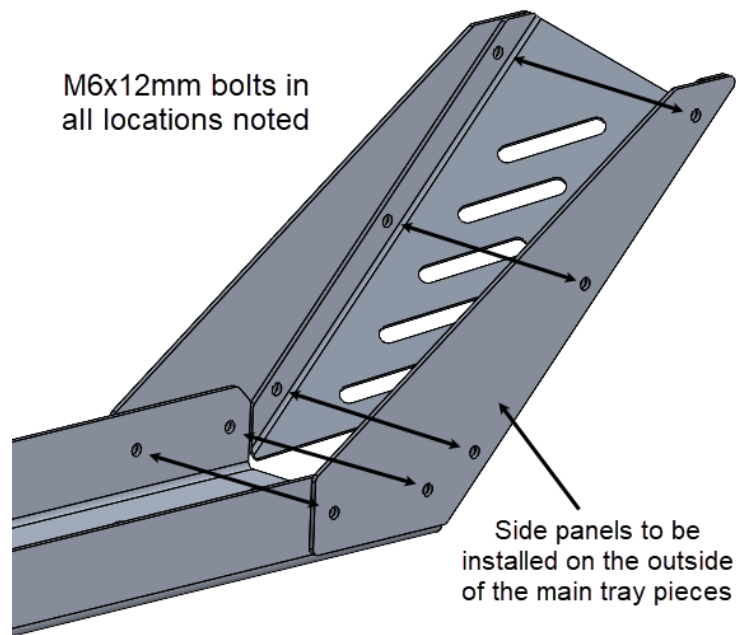

2: Install frame brackets as shown in diagrams 3 and 4. Install assembly using only the internal tie-down brace until all pieces have been set in place and snugged, as some of the hardware will be hidden inside. Loosely installing tray to frame brackets will help locate everything. After everything has been assembled, install external tie-down brace using (2) Eye bolts and hardware, and (2) M6x12mm bolts. See *diagram 4*. Note hardware designations in diagrams 3 and 4. Note that some of the M8 bolt locations will be used to install the tray assembly to the frame brackets

Diagram 3

Top View

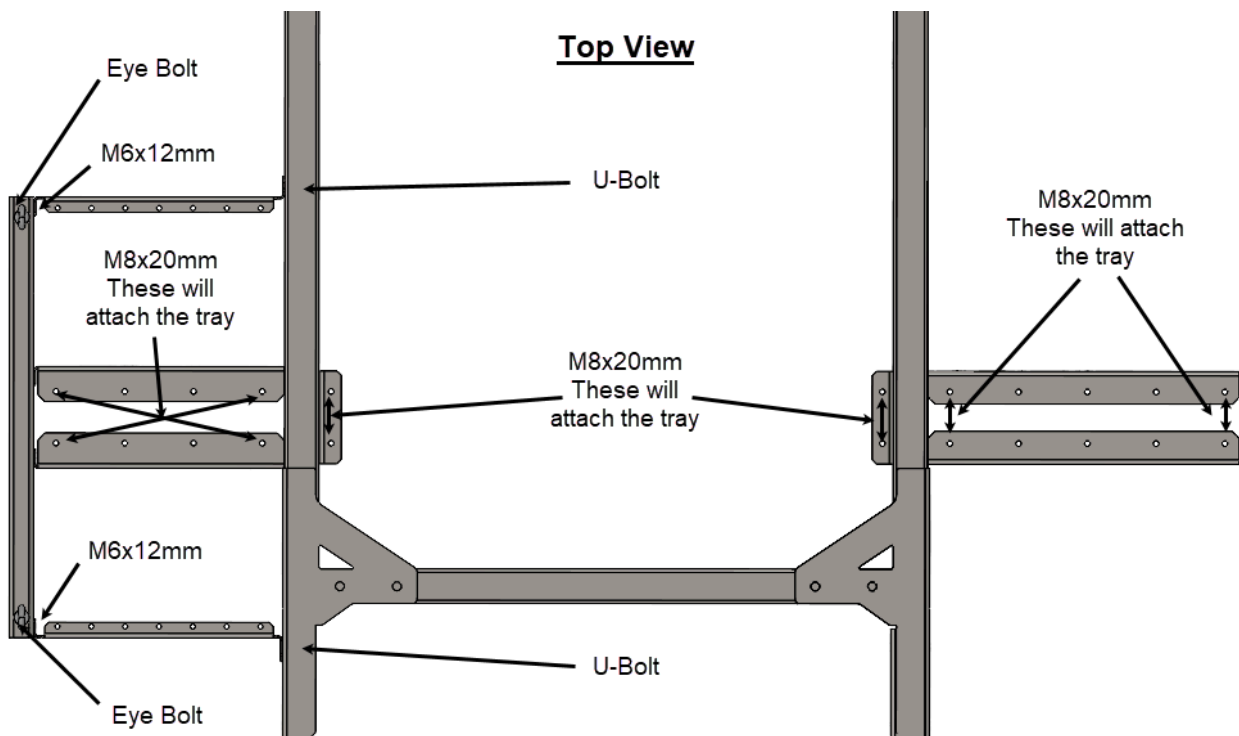
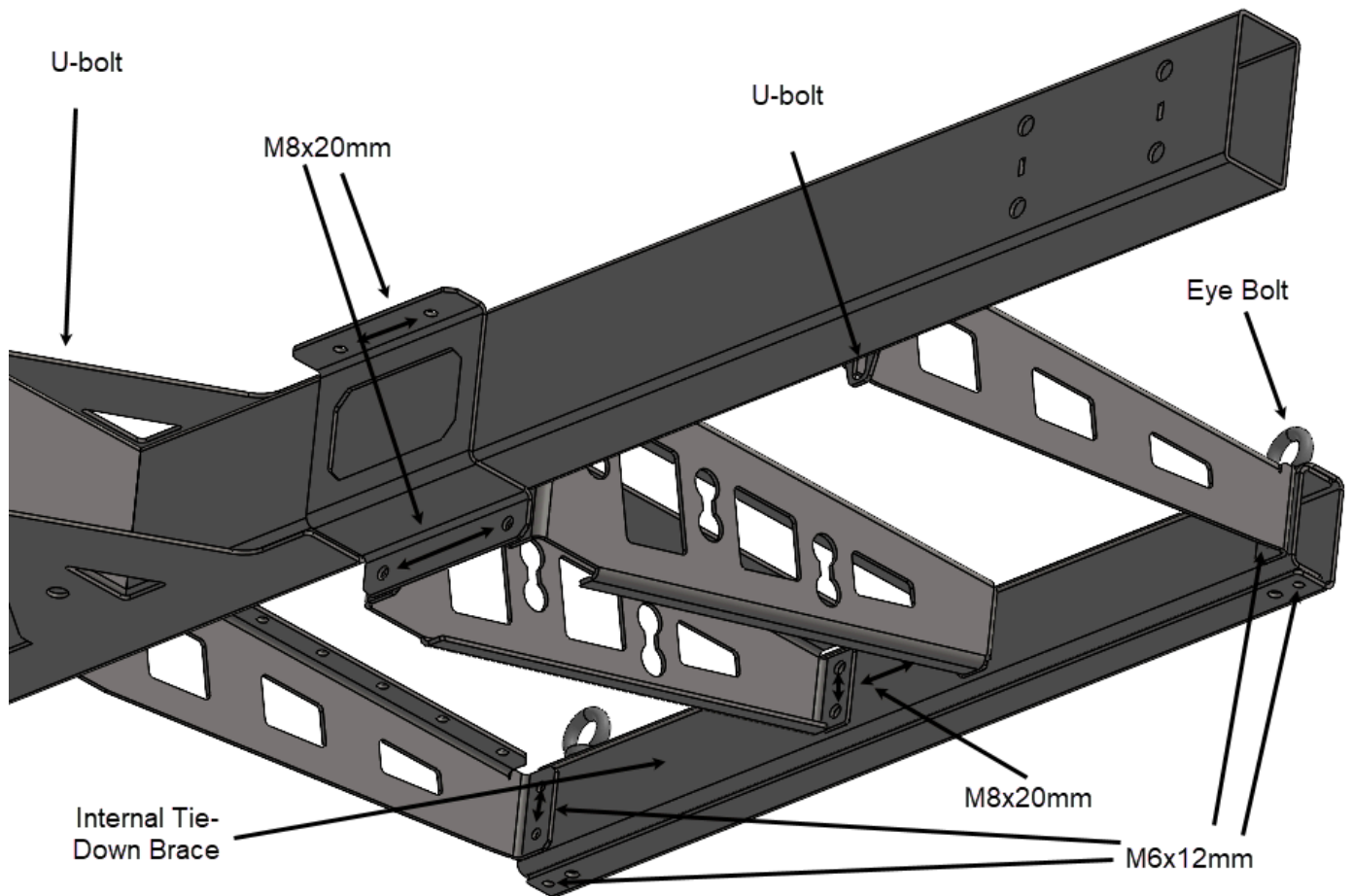

Diagram 4



Share Your Photos

We take great pride in building our products and we hope that pride extends to you after installing your ATK - Bike Mount. If you are able to share your photos online (Facebook and Instagram), please tag **@AmericanAdventureLab**. We would love to see how it turned out and give you some reciprocal attention in return!

Congrats! You're all done!

Thank you!

At American Adventure Lab, we strive to improve anywhere we can. If you experience any issues with this product or have any suggestions, please let us know.

